

## EJ100 Toggle

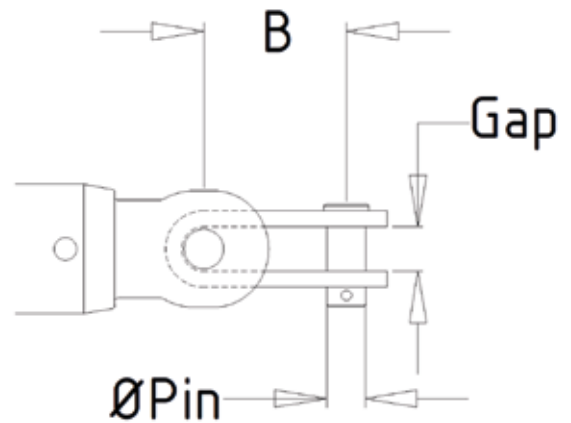

The toggle between the hull and the cylinder allows perfect alignment of the load in all working conditions in the various settings.

A simple expedient to minimize the side loads.



### Technical Data

Ref.	Description	Gap / Pin (in)	B (mm)
EJ100-10	-10 Cylinder toggle	1/2	50
EJ100-17	-12/-17 Cylinder toggle	5/8	60
EJ100-22	-22 Cylinder toggle	3/4	70
EJ100-30	-30 Cylinder toggle	7/8	80
EJ100-40	-40 Cylinder toggle	1	90
EJ100-60	-60 Cylinder toggle	1 1/4	115
EJ100-90	-90 Cylinder toggle	1 3/8	115